



# Construction Notice

## Cable Pulling at Hayden Ferry Lakeside Intersection

Dates: October 19 – 30, 2020 | Work Hours: 12:00 a.m. - 12:00 p.m.

### WORK DESCRIPTION

- Pulling cables across Hayden Ferry Lakeside intersection
- Pedestrian access will be maintained
- Bike lanes will be shared with vehicles in work zone
- Access to residences and businesses will be maintained

### IMPACTS

#### **TRAFFIC:**

No left turns at Hayden Ferry Lakeside intersection. Access will be right in/right out only.

#### **NOISE:**

Every effort will be made to mitigate noise to nearby residents and hotels during construction.

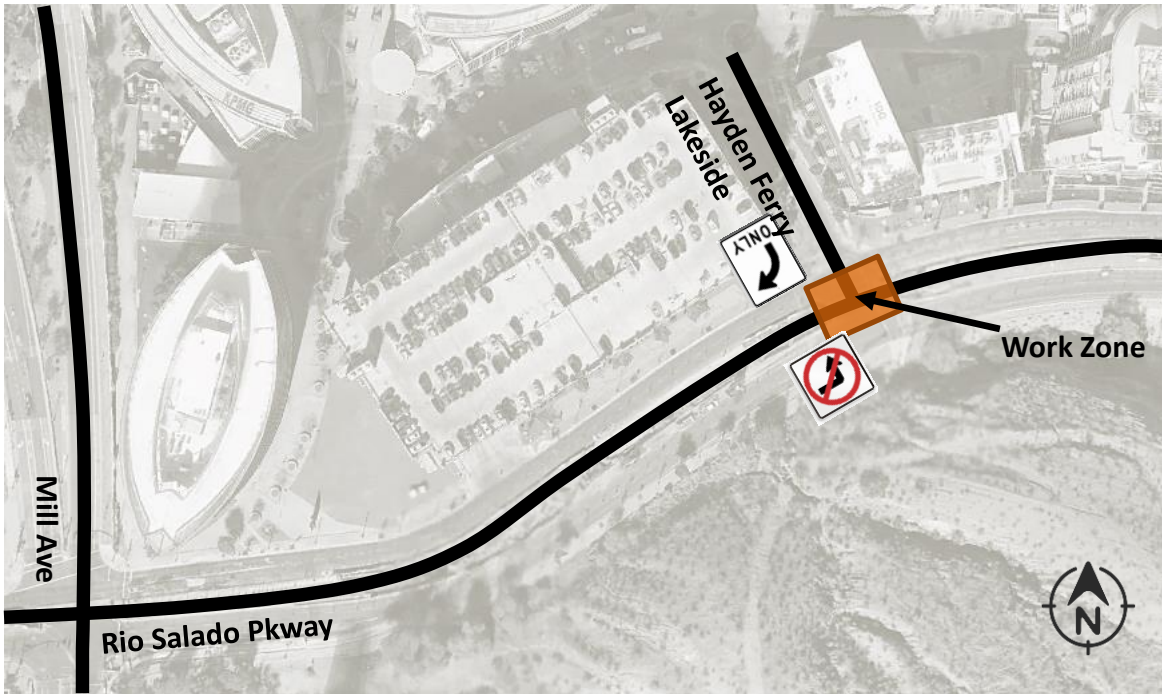

*Work days and hours subject to change due to nature of work in different areas and/or unforeseen circumstances.*



Valley Metro Community Outreach Coordinators:  
Jordan Brackett  
602.744.5552 | [jbrackett@valleymetro.org](mailto:jbrackett@valleymetro.org)  
Bree Boehlke  
602.256.5822 | [bboehlke@valleymetro.org](mailto:bboehlke@valleymetro.org)



To subscribe to weekly email updates, contact Jordan Brackett. For more information, please visit [valleymetro.org/tempestreetcar](http://valleymetro.org/tempestreetcar).